

# HONEYWELL RABO®

## Rotary Gas Meter

### BRIEF INFORMATION

- MAOP 290 psig, ANSI Class 125/150 Flange
- Temperature range -40 F to +140 F
- Meets ANSI B109.3 and EN12480:2015
- Measurement Canada Approval AG-0628, CRN Registration OF19987. 5
- Approvals pursuant to MID/PED/ATEX directives
- For use on dry natural gas and noncorrosive industrial gases
- Suitable for Indoor or Outdoor installation



### APPLICATIONS

Honeywell has combined tried and tested product features of the Elster and Instromet rotary meter product lines with new developments into a single product: the new Honeywell RABO Rotary Meter.

Rotary-All-By-One, "RABO," simple, all-in-one!

### OPERATING PRINCIPLE

The Rotary Gas meter utilizes the rotary-type positive displacement principle of operation which makes volumetric measurements by displacing finite volumes of gas. The positive displacement occurs within a cavity formed between the meter's internal housing and its rotating impellers. The counter-rotating "figure-8" impellers turn as a result of pressure drop across the meter's inlet and outlet created as downstream gas is consumed. The rotating impellers separate the flowing gas into small, finite, volumes and are counted using a mechanical index.

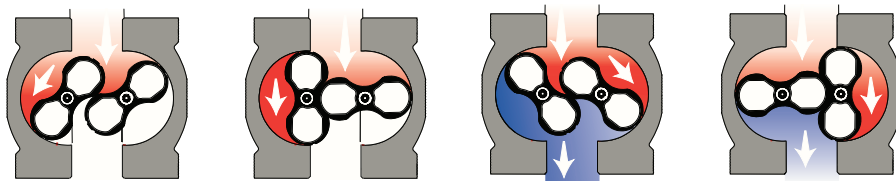

As the left impeller rotates toward the vertical position gas enters the cavity created between the impeller and the housing.

When the left impeller reaches the vertical position, a finite volume of gas is captured in the left cavity.

As the impellers continue to turn, the volume of gas in the left cavity is discharged. Simultaneously, gas is entering the space between the right impeller and housing.

After further rotation, the right impeller becomes vertical and a finite volume of gas is captured in the right cavity.

### FEATURES & BENEFITS

- 5 meters sizes with capacities ranging from 3,500 up to 23,000 CFH.
- 2", 3", 4" and 6" ANSI Class 125/150 flanged connections
- High rangeability across the flow range
- Low pressure drop
- Differential pressure test ports are standard
- Two 1/4" NPT taps on inlet
- Non-lubricated and non-resettable index
- End view, rotatable index
- Heavy duty, compact design
- High impact-resistant, ultraviolet stabilized index cover
- Anodized extruded aluminum body and impellers
- Anodized forged aluminum case covers
- Permanently lubricated bearings

#### Options

- Pulse outputs
- Thermowell
- Index masking
- Gasket strainers
- Flange bolts and gaskets
- AMR mounting Bracket
- Differential pressure gauge kit
- Instrument Drive
- Corrector mounting bracket
- Direct mount TCI or EC350
- 1 1/2" NPT Mounting Kit

# HONEYWELL RABO GAS METER CONSTRUCTION

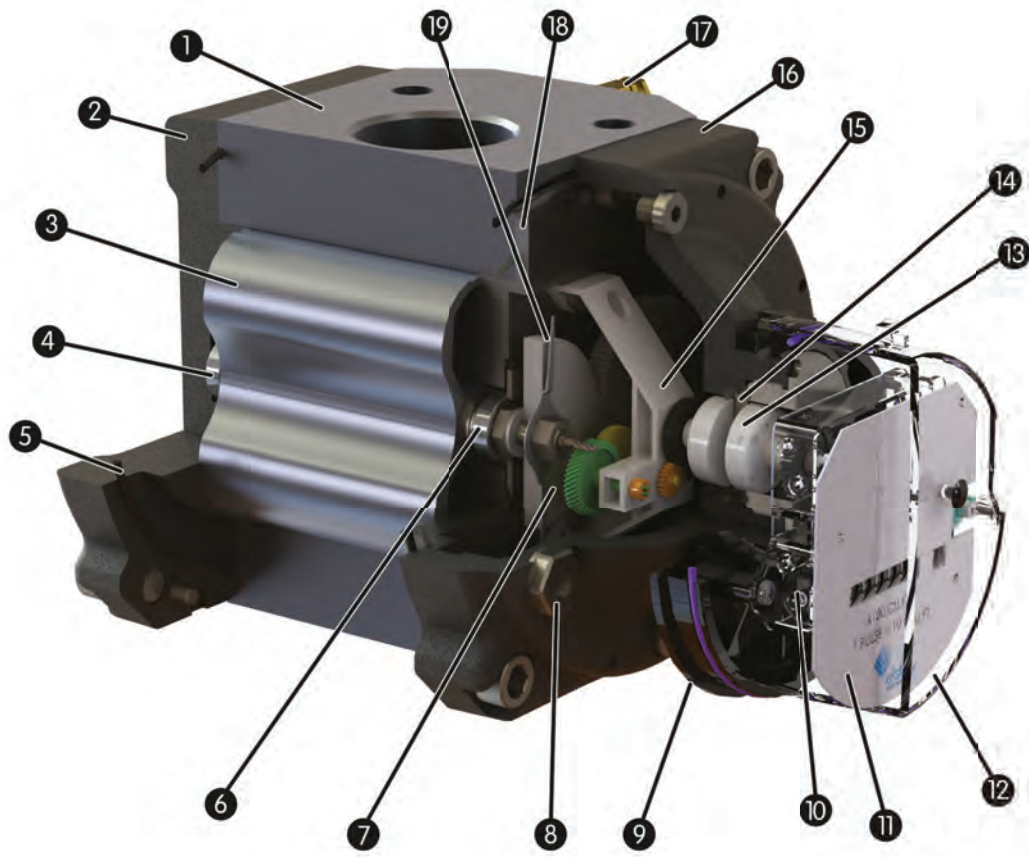

| METER CONSTRUCTION |                     |   |
|--------------------|---------------------|---|
| No.                | Part Name           | Material  |
| 1                  | Case                | Extruded Aluminum, Hard-coat Anodized             |
| 2                  | Back Case Cover     | Forged Aluminum, Hard-coat Anodized               |
| 3                  | Impellers           | Extruded Aluminum, Hard-coat Anodized             |
| 4                  | Back Bearing        | Stainless Steel, Permanently Lubricated, Shielded |
| 5                  | O-Ring              | Buna-N  |
| 6                  | Front Bearing       | Stainless Steel, Lubricated, Shielded             |
| 7                  | Timing Gears        | Carbon Steel                                      |
| 8                  | Sight Glasses       | Aluminum Housing                                  |
| 9                  | Index Base          | High Performance Polyamide (Nylon)                |
| 10                 | Index               | Polycarbonate                                     |
| 11                 | Index Masking Plate | Aluminum  |
| 12                 | Index Cover         | Polycarbonate, UV Resistant                       |
| 13                 | Index Drive         | Magnet  |
| 14                 | Pressure Plate      | Stainless Steel                                   |
| 15                 | Gear Box            | Polyoxymethylene                                  |
| 16                 | Front Case Cover    | Forged Aluminum, Hard-coat Anodized               |
| 17                 | Pressure Test Ports | Brass Housing                                     |
| 18                 | Front Bearing Plate | Aluminum, Hard-coat Anodized                      |
| 19                 | Oil Slinger         | Steel   |
|                    | Lubricating Oil     | Shell Morlina                                     |

## OPTIONS PULSE OUTPUTS

Honeywell Rotary Gas flow meters come equipped with a drive magnet as standard equipment for easy adaptability of a low frequency pulse generator. The standard E1 Pulse Type provides 1 pulse per revolution and the optional E10 Pulse Type provides 10 pulses per revolution. The pulse generators are attachable to the exterior of the index cover, and can be retrofitted or changed without opening the index. They also have sealing capability to visually detect tampering.

| MODEL   | DESCRIPTION                               |
|---------|---|
| IN-S10  | 8' cable                                  |
| IN-S10A | 14" length cable for Itron AMR connection |
| IN-S11  | 1 connector                               |
| IN-S12  | 2 connectors                              |
| IN-S11P | Pulser cable for Dresser™ model 5 prover  |

All models, except IN-S10A, include 2 independent switches and a tamper circuit. Pulse value is 10 acf (0.28 x am<sup>3</sup>) for all meter sizes. IN-S11 and IN-S12 come with mating connector, no cable included. The standard pulse value is 10 acf for 3.5M, 5.5M, 9M, and 14M. The standard pulse value is 100 acf for 23M.

| TECHNICAL SPECIFICATIONS        |                 |      |      |      |
|---------------------------------|-----------------|------|------|------|
| DESCRIPTION                     | Min             | Typ. | Max. | Unit |
| Voltage (U)                     | 1               |      | 24   | V    |
| Current (I)                     | 2               |      | 25   | mA   |
| Power (P)                       |                 |      | 250  | mW   |
| Static Contact Resistance       |                 |      | 200  | mΩ   |
| Insulation Resistance           | 10 <sup>9</sup> |      |      | Ω    |
| Breakdown Voltage               | 100             |      | 100  | VDC  |
| Switching Time Including Bounce |                 | 0.5  |      | ms   |
| Release Time                    |                 | 0.1  |      | ms   |

Temperature range: -40°C ... +70°C

IP-Class: IP67

Explosion protection: Ex II 2 G EEx ia 2C T4



Pulse Output



IN-S10, IN-S10A, IN-S11, and IN-S12 pulse output connections



Pulser cable for transfer prover

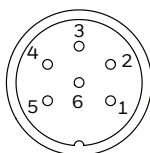
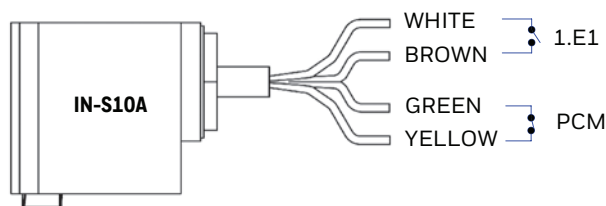
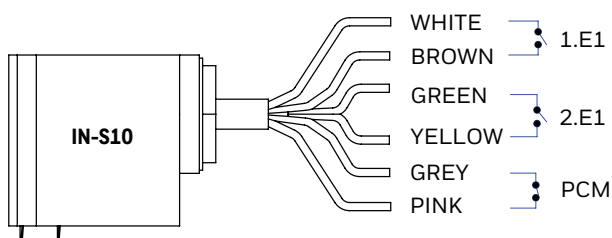

| PULSER PIN-OUT CONNECTIONS |                 |                  |                  |
|----------------------------|-----------------|------------------|------------------|
| CONNECTORS                 | 1.E1            | 2.E1             | PCM              |
| IN-S11                     | 1 + 2           | 5 + 6            | 3 + 4            |
| IN-S12                     | 1 + 2<br>(Back) | 1 + 2<br>(Front) | 3 + 4<br>(Front) |



Corrector Mounting Bracket



AMR Mounting Bracket

## DIRECT MOUNT TCI OR EC350

The RABO meter can be shipped by the factory with either a Honeywell Mercury Instruments Temperature Compensation Index (TCI) or an Electronic Volume Corrector (EC350) directly mounted to it, with or without an Automated Meter Reading (AMR) device attached to it.

The TCI is an advanced, yet simple to use, electronic temperature compensating index. The TCI is the market leader throughout the US and Canada for electronic temperature compensation on integrally mounted rotary meter applications.

The RABO meter can be fitted with the EC350, which is Honeywell's latest Gas Volume Corrector platform that corrects for pressure, temperature and supercompressibility factors. The EC350 provides highly accurate and stable pressure measurement, long battery life, increased audit trail memory, and options for internal cellular communications.



RABO with TCI



RABO with Direct-mount EC350 corrector

## INSTRUMENT DRIVE

- Provides an output shaft to drive instruments
- Accepts known instruments via industry standard mounting plate
- CW shaft rotation
- 1:1 gear ratio
- Replaceable breakaway feature for drive dog
- <0.1% effect on accuracy at  $Q_{min}$
- Able to retrofit in the field



RABO with Instrument Drive

## THERMOWELL

316 SS, 0.25" Bore Model

### MODEL

1/4" NPT with Gland



Thermowell

## INDEX MASKING

### MASK

4 X 1,000 CF

5 X 100 CF (Std)

5 X 1,000 CF

6 x 10 CF

6 x 100 CF

Blank



Index Masking Plate

## OPTIONS

### GASKETS, STRAINERS, BOLTS

Gaskets and bolts are necessary for mounting a meter in the gas line. Gaskets and strainers are high quality Garlock® BLUE-GARD® Style 3000, and Grade 5 bolts are Xylan® coated for increased corrosion resistance and reduced friction. Gasket strainers are an effective way to protect the meter and downstream equipment from weld slag and other debris in the gas system.

#### TECHNICAL SPECIFICATIONS

|                 |                 |            |     |
|-----------------|-----------------|------------|-----|
| Gasket Strainer | 2" ANSI 125/150 | Full Face* | 80  |
| Gasket Strainer | 3" ANSI 125/150 | Full Face* | 80  |
| Gasket Strainer | 4" ANSI 125/150 | Full Face* | 80  |
| Gasket Strainer | 6" ANSI 125/150 | Full Face* | 80  |
| Gasket Strainer | 2" ANSI 125/150 | Ring       | 40  |
| Gasket Strainer | 3" ANSI 125/150 | Ring       | 40  |
| Gasket Strainer | 4" ANSI 125/150 | Ring       | 40  |
| Gasket Strainer | 6" ANSI 125/150 | Ring       | 40  |
| Gasket Strainer | 2" ANSI 125/150 | Ring       | 20  |
| Gasket Strainer | 3" ANSI 125/150 | Ring       | 20  |
| Gasket Strainer | 4" ANSI 125/150 | Ring       | 20  |
| Gasket Strainer | 6" ANSI 125/150 | Ring       | 20  |
| Gasket Strainer | 2" ANSI 125/150 | Full Face* | 20  |
| Gasket Strainer | 3" ANSI 125/150 | Full Face* | 20  |
| Gasket Strainer | 4" ANSI 125/150 | Full Face* | 20  |
| Gasket Strainer | 6" ANSI 125/150 | Full Face* | 20  |
| Gasket & Bolts  | 2" ANSI 125/150 | Ring       | N/A |
| Gasket & Bolts  | 3" ANSI 125/150 | Ring       | N/A |
| Gasket & Bolts  | 4" ANSI 125/150 | Ring       | N/A |
| Gasket & Bolts  | 6" ANSI 125/150 | Ring       | N/A |

\*Not rated for full MAOP of the meter.



Gasket Strainers

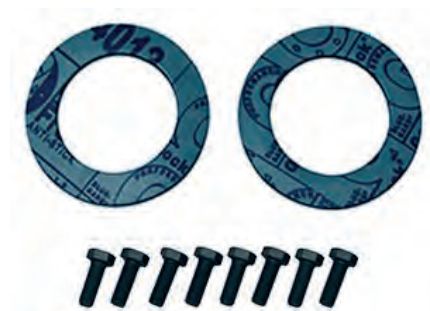

Gasket and Bolt Kits

## HONEYWELL RABO GAS METER PERFORMANCE

#### PERFORMANCE

|   | Units                | 3.5M/G65    | 5.5M/G100   | 9M/G160     | 14M/G250    | 23M/G400    |
|---|----------------------|-------------|-------------|-------------|-------------|-------------|
| Rangeability                            |                      | 90:1        | 160:1       | 160:1       | 160:1       | 160:1       |
| Start Rate                              | acfh [am3/h]         | 1.3 [0.04]  | 0.9 [0.03]  | 2.5 [0.07]  | 2.5 [0.07]  | 3.6 [0.10]  |
| Stop Rate                               | acfh [am3/h]         | 1.1 [0.03]  | 0.8 [0.02]  | 1.9 [0.05]  | 2.3 [0.07]  | 3.3 [0.09]  |
| Flow Rate at 1/2" w.c. DP, Gas          | acfh [am3/h]         | 2,715 [77]  | 4,074 [115] | 5,722 [162] | 6,740 [191] | 7,400 [210] |
| Differential Pressure at 100% Flow Rate | in. w.c. [mBar]      | 1.46 [3.64] | 1.23 [3.06] | 1.70 [4.23] | 2.65 [6.60] | 3.9 [9.80]  |
| Pulse outputs (English / metric)        | acf / m <sup>3</sup> | 10 / 1.0    | 10 / 1.0    | 10 / 1.0    | 10 / 1.0    | 100 / 1.0   |

Note: Values are for air, except Flow rate at 1/2" w.c.DP, which are natural gas values.

### ACCURACY CURVE

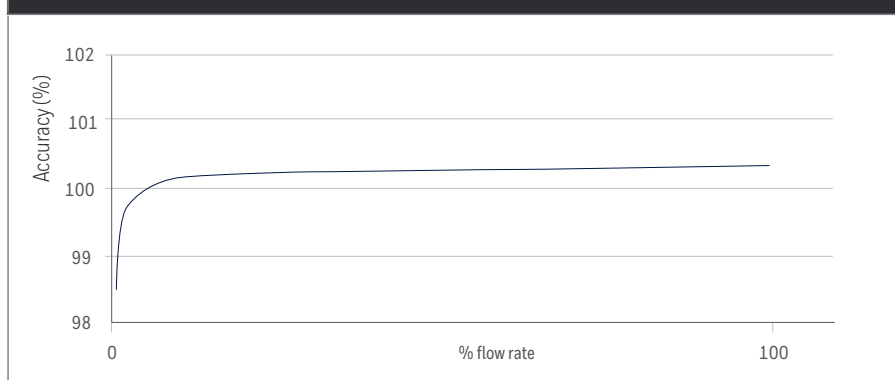

## RABO SIZING CHART

Using the chart below, select the appropriate meter by using the Maximum Instantaneous Flow Rate (scfh) and the Minimum Operating Pressure (psig) at any given point in time.

Example: A flow rate of 25,000 scfh and an operating pressure range of 75-100 psig would require a 5.5M meter based on a 75 psig minimum inlet pressure.

| SIZING CHART |        |   |         |           |         |         |         |          |         |          |          |
|--------------|--------|---|---------|-----------|---------|---------|---------|----------|---------|----------|----------|
| Model        |        | 3.5M/G65  |         | 5.5M/G100 |         | 9M/G160 |         | 14M/G250 |         | 23M/G400 |          |
| psig         | [Barg] | Corrected Capacity in scfh [sm <sup>3</sup> /h] |         |           |         |         |         |          |         |          |          |
| 0.25         | [0.0]  | 3,500   | [100]   | 5,500     | [160]   | 9,000   | [250]   | 14,000   | [400]   | 23,000   | [650]    |
| 2            | [0.1]  | 3,900   | [110]   | 6,100     | [170]   | 10,000  | [280]   | 15,600   | [440]   | 25,300   | [715]    |
| 5            | [0.3]  | 4,600   | [130]   | 7,200     | [200]   | 11,900  | [340]   | 18,400   | [520]   | 30,400   | [850]    |
| 10           | [0.7]  | 5,800   | [160]   | 9,100     | [260]   | 14,900  | [420]   | 23,200   | [660]   | 38,100   | [1,070]  |
| 20           | [1.4]  | 8,200   | [230]   | 12,800    | [360]   | 21,000  | [590]   | 32,700   | [930]   | 53,700   | [1,510]  |
| 30           | [2.1]  | 10,500  | [300]   | 16,600    | [470]   | 27,100  | [770]   | 42,200   | [1,190] | 69,300   | [1,930]  |
| 40           | [2.8]  | 12,900  | [370]   | 20,300    | [570]   | 33,200  | [940]   | 51,700   | [1,460] | 84,800   | [2,370]  |
| 50           | [3.4]  | 15,300  | [430]   | 24,000    | [680]   | 39,300  | [1,110] | 61,200   | [1,730] | 100,400  | [2,810]  |
| 60           | [4.1]  | 17,700  | [500]   | 27,800    | [790]   | 45,500  | [1,290] | 70,700   | [2,000] | 116,300  | [3,250]  |
| 75           | [5.2]  | 21,200  | [600]   | 33,400    | [950]   | 54,600  | [1,550] | 85,000   | [2,410] | 139,500  | [3,920]  |
| 100          | [6.9]  | 27,200  | [770]   | 42,700    | [1,210] | 69,900  | [1,980] | 108,700  | [3,080] | 178,600  | [5,000]  |
| 150          | [10.3] | 39,100  | [1,110] | 61,400    | [1,740] | 100,400 | [2,840] | 156,300  | [4,430] | 256,700  | [7,200]  |
| 175          | [12.1] | 45,000  | [1,270] | 70,700    | [2,000] | 115,700 | [3,280] | 180,000  | [5,100] | 296,700  | [8,290]  |
| 250          | [17.2] | 62,800  | [1,780] | 98,700    | [2,790] | 161,500 | [4,570] | 251,300  | [7,120] | 412,700  | [11,580] |
| 290          | [20.0] | 72,300  | [2,050] | 113,700   | [3,220] | 186,000 | [5,270] | 289,300  | [8,190] | 475,300  | [13,300] |

Note: All capacities are based on 14.4 psia atmospheric pressure, 14.73 psia base pressure, and 60° F base temperature.

## RABO-STANDARD COUNTER: DIMENSIONS WEIGHTS

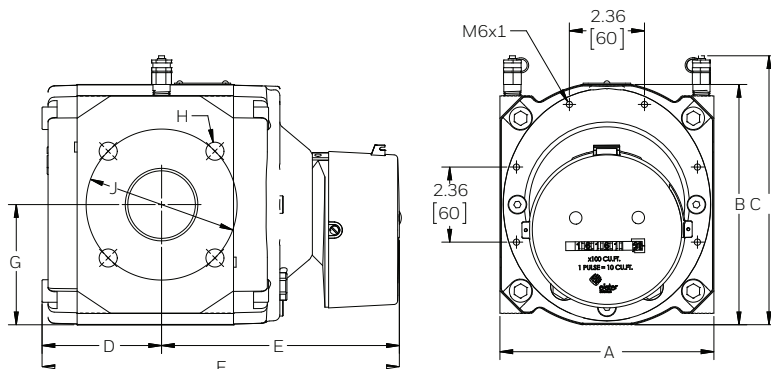

| DIMENSIONS AND WEIGHTS |           |                       |       |           |       |                       |       |           |       |                       |       |  |  |
|------------------------|-----------|-----------------------|-------|-----------|-------|-----------------------|-------|-----------|-------|-----------------------|-------|--|--|
| Units                  |           | 3.5M/G65              |       | 5.5M/G100 |       | 9M/G160               |       | 14M/G250  |       | 23M/G400              |       |  |  |
| A                      | in. [mm]  | 6.75                  | [171] | 6.75      | [171] | 9.5                   | [241] | 9.5       | [241] | 9.5                   | [241] |  |  |
| B                      | in. [mm]  | 7.56                  | [192] | 7.56      | [192] | 10.08                 | [256] | 10.08     | [256] | 11.03                 | [280] |  |  |
| C                      | in. [mm]  | 8.63                  | [219] | 8.63      | [219] | 10.75                 | [273] | 10.75     | [273] | 12.40                 | [315] |  |  |
| D                      | in. [mm]  | 3.78                  | [96]  | 5.43      | [138] | 5.16                  | [131] | 6.14      | [156] | 7.48                  | [190] |  |  |
| E                      | in. [mm]  | 7.52                  | [191] | 9.17      | [233] | 10.67                 | [271] | 11.65     | [296] | 12.60                 | [320] |  |  |
| F                      | in. [mm]  | 11.26                 | [286] | 14.61     | [371] | 15.83                 | [402] | 17.76     | [451] | 20.08                 | [510] |  |  |
| G                      |           | 3.78                  | [96]  | 3.78      | [96]  | 5.04                  | [128] | 5.04      | [128] | 5.51                  | [140] |  |  |
| Nom. Pipe Size*        | in. [mm]  | 2                     |       | 3         |       | 3                     |       | 4         |       | 4/6                   |       |  |  |
| Bolt Size, H           |           | 5/8" - 11             |       | 5/8" - 11 |       | 5/8" - 11             |       | 5/8" - 11 |       | 5/8" - 11 / 3/4" - 10 |       |  |  |
| # Bolts / Flange       |           | 4                     |       | 4         |       | 4                     |       | 8         |       | 8                     |       |  |  |
| Bolt Circle, J         | in. [mm]  | 4.75                  | [121] | 6         | [152] | 6                     | [152] | 7.5       | [191] | 9.42                  | [240] |  |  |
| Shipping Weight        | lbs. [kg] | 29.8                  | [14]  | 37.7      | [17]  | 73.9                  | [34]  | 82.3      | [37]  | 97.9                  | [44]  |  |  |
| Carton Size            | in. [mm]  | 18.3L x 10.6W x 12.6H |       |           |       | 23.6L x 13.0W x 13.4H |       |           |       | 24.8L x 13.4W x 15.0H |       |  |  |
|                        |           | 465L x 270W x 320H    |       |           |       | 600L x 330W x 340H    |       |           |       | 630L x 340W x 380H    |       |  |  |

## RABO-ID: DIMENSIONS WEIGHTS

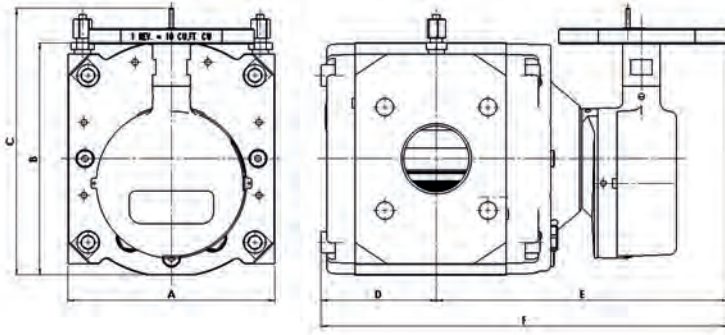

### DIMENSIONS AND WEIGHTS

|                 | Units     | 3.5M/G65              |       | 5.5M/G100             |       | 9M/G160               |       | 14M/G250              |       | 23M/G400              |       |
|-----------------|-----------|-----------------------|-------|-----------------------|-------|-----------------------|-------|-----------------------|-------|-----------------------|-------|
| A               | in. [mm]  | 6.75                  | [171] | 6.75                  | [171] | 9.5                   | [241] | 9.5                   | [241] | 9.5                   | [241] |
| B               | in. [mm]  | 7.56                  | [192] | 7.56                  | [192] | 10.08                 | [256] | 10.08                 | [256] | 11.09                 | [280] |
| C               | in. [mm]  | 8.78                  | [223] | 8.78                  | [223] | 11.30                 | [287] | 11.30                 | [287] | 12.95                 | [330] |
| D               | in. [mm]  | 3.78                  | [96]  | 5.43                  | [138] | 5.16                  | [131] | 6.14                  | [156] | 7.48                  | [190] |
| E               | in. [mm]  | 9.53                  | [242] | 11.23                 | [285] | 12.72                 | [323] | 13.67                 | [347] | 14.62                 | [371] |
| F               | in. [mm]  | 13.31                 | [338] | 16.66                 | [423] | 17.88                 | [454] | 19.81                 | [503] | 22.10                 | [561] |
| Shipping Weight | lbs. [kg] | 32.3                  | [15]  | 40.2                  | [19]  | 76.4                  | [35]  | 84.8                  | [39]  | 100.4                 | [46]  |
| Carton Size     | [in.]     | 18.3L x 10.6W x 12.6H |       | 18.3L x 10.6W x 12.6H |       | 23.6L x 13.0W x 13.4H |       | 23.6L x 13.0W x 13.4H |       | 24.8L x 13.4W x 15.0H |       |
|                 | [mm]      | 465L x 270W x 320H    |       | 465L x 270W x 320H    |       | 600L x 330W x 340H    |       | 600L x 330W x 340H    |       | 630L x 340W x 380H    |       |

## RABO-TCI: DIMENSIONS WEIGHTS

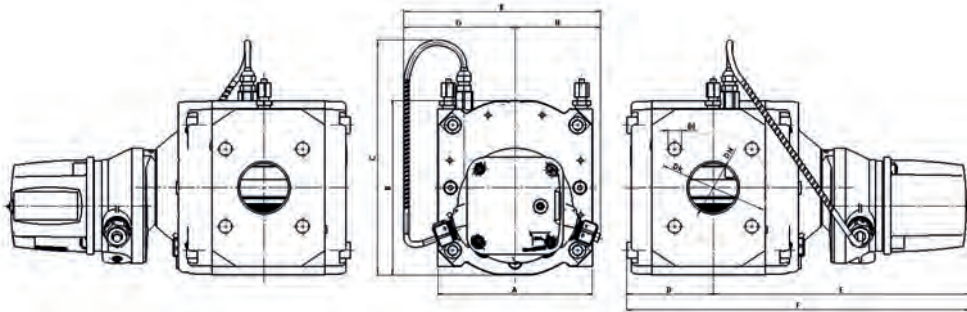

### DIMENSIONS AND WEIGHTS

|                 | Units     | 3.5M/G65           |       | 5.5M/G100 |       | 9M/G160          |       | 14M/G250 |       | 23M/G400 |       |
|-----------------|-----------|--------------------|-------|-----------|-------|------------------|-------|----------|-------|----------|-------|
| A               | in. [mm]  | 6.75               | [171] | 6.75      | [171] | 9.5              | [241] | 9.5      | [241] | 9.5      | [241] |
| B               | in. [mm]  | 7.56               | [192] | 7.56      | [192] | 10.08            | [256] | 10.08    | [256] | 11.03    | [280] |
| C               | in. [mm]  | 10.24              | [260] | 10.24     | [260] | 12.76            | [324] | 12.76    | [324] | 13.71    | [348] |
| D               | in. [mm]  | 3.78               | [96]  | 5.43      | [138] | 5.16             | [131] | 6.14     | [156] | 7.48     | [190] |
| E               | in. [mm]  | 11.18              | [284] | 12.83     | [326] | 14.33            | [364] | 15.31    | [389] | 16.26    | [413] |
| F               | in. [mm]  | 14.96              | [380] | 18.27     | [464] | 19.49            | [495] | 21.46    | [545] | 23.74    | [603] |
| G               | in. [mm]  | 4.92               | [125] | 4.92      | [125] | 4.92             | [125] | 4.92     | [125] | 4.92     | [125] |
| H               | in. [mm]  | 3.74               | [95]  | 3.74      | [95]  | 3.74             | [95]  | 3.74     | [95]  | 3.74     | [95]  |
| K               | in. [mm]  | 8.66               | [220] | 8.66      | [220] | 8.66             | [220] | 8.66     | [220] | 8.66     | [220] |
| Shipping Weight | lbs. [kg] | 32.8               | [15]  | 40.7      | [19]  | 76.9             | [35]  | 85.3     | [39]  | 100.9    | [46]  |
| Carton Size     | [in.]     | 22L x 12W x 16H    |       |           |       | 28L x 16W x 19H  |       |          |       |          |       |
|                 | [mm]      | 559L x 305W x 153H |       |           |       | 711 x 406 x 483H |       |          |       |          |       |

# RABO-EC350 CORRECTOR: DIMENSIONS WEIGHTS

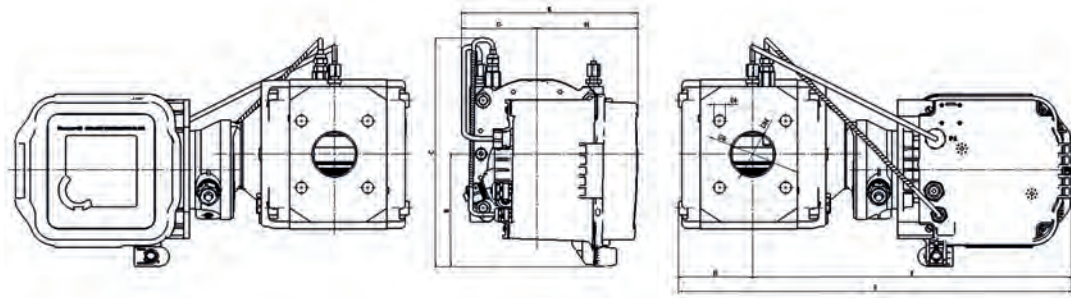

| DIMENSIONS AND WEIGHTS |           |                    |       |           |       |                  |       |                  |       |          |       |
|------------------------|-----------|--------------------|-------|-----------|-------|------------------|-------|------------------|-------|----------|-------|
|                        | Units     | 3.5M/G65           |       | 5.5M/G100 |       | 9M/G160          |       | 14M/G250         |       | 23M/G400 |       |
| C                      | in. [mm]  | 11.42              | [290] | 11.42     | [290] | 13.00            | [330] | 13.00            | [330] | 13.95    | [354] |
| D                      | in. [mm]  | 3.78               | [96]  | 5.43      | [138] | 5.16             | [131] | 6.14             | [156] | 7.48     | [190] |
| E                      | in. [mm]  | 16.22              | [412] | 17.87     | [454] | 19.37            | [492] | 20.35            | [517] | 21.30    | [541] |
| F                      | in. [mm]  | 20.00              | [508] | 23.31     | [592] | 24.53            | [623] | 26.50            | [673] | 28.78    | [731] |
| G                      | in. [mm]  | 3.86               | [98]  | 3.86      | [98]  | 5.12             | [130] | 5.12             | [130] | 5.12     | [130] |
| H                      | in. [mm]  | 5.12               | [130] | 5.12      | [130] | 5.12             | [130] | 5.12             | [130] | 5.12     | [130] |
| K                      | in. [mm]  | 8.98               | [228] | 8.98      | [228] | 10.24            | [260] | 10.24            | [260] | 10.24    | [260] |
| R                      | in. [mm]  | 5.71               | [145] | 5.71      | [145] | 5.71             | [145] | 5.71             | [145] | 5.71     | [145] |
| Shipping Weight        | lbs. [kg] | 36.0               | [17]  | 48.0      | [22]  | 83.0             | [38]  | 94.0             | [43]  | 109.6    | [50]  |
| Carton Size            | [in.]     | 22L x 12W x 16H    |       |           |       | 28L x 16W x 19H  |       | 30L x 16W x 19H  |       |          |       |
|                        | [mm]      | 559L x 305W x 153H |       |           |       | 711 x 406 x 483H |       | 762 x 406 x 483H |       |          |       |

## ORDERING INFORMATION

**Meter Model**  
**Standard Counter**  
**Instrument Drive**  
**TCI - Direct Mount**  
**EC350 - Direct Mount**

- Options**
- Index Masking
  - Custom Badge
  - Thermowell
  - Pulser
  - Gasket Strainer
  - Gasket and Bolt
  - 1 1/2" NPT Mounting Kit \*
  - Measurement Canada Sealing
  - Metric Index
  - Mounting brackets for corrector or AMR device
  - Pulser Type - E1 or E10

\* Only available in certain applications

**For more information**  
 To learn more about Honeywell  
 Honeywell's Gas Solutions, visit  
[www.honeywellprocess.com](http://www.honeywellprocess.com)  
 Gas Metering and Regulation  
 or contact your Honeywell representative

**Honeywell Process Solutions**  
 1250 West Sam Houston Parkway South  
 Houston, TX 77042  
 USA Tel: +1 832 252 3500  
[www.honeywellprocess.com](http://www.honeywellprocess.com)

**Distributed by:**  
**Linc Energy Systems**  
[www.lincenergysystems.com](http://www.lincenergysystems.com)



**ISO 9001**  
 QMI-SAI Global

**THE  
 FUTURE  
 IS  
 WHAT  
 WE  
 MAKE IT**

